

MINIFIX

New range
MINIFIX



DESCRIPTION

The MINIFIX mounting comprises an elastomer pad with an anti-slip ridged surface and a threaded stud allowing accurate height adjustment of equipment.

Made in two hardnesses (50 and 80 Sh) the MINIFIX mounting is perfectly suited to a variety of applications and is delivered complete with fixing nuts and washers. MINIFIX mounting nuts and screws are made of steel or stainless steel.

CHARACTERISTICS

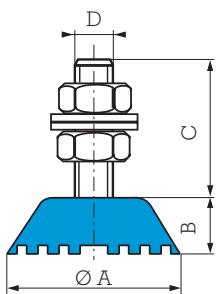

Reference Stainl. steel	Reference Steel	Hardness	Colour	Ø A mm	B mm	C mm	D	Load range daN
-	530801	50 SBR 80 Nitrile	grey black	32	15	38	M8 stud	5 - 30 15 - 70
-	530802*	50 SBR 80 Nitrile	grey black	46	15	-	M10 nut	10 - 80 25 - 200
530806	530805	50 SBR 80 Nitrile	grey black	46	15	38	M10 stud	10 - 40 25 - 100
-	530807	50 SBR 80 Nitrile	grey black	70	25.5	55.5	M12 stud	50 - 120 100 - 350

* Threaded centre hole.
See current price list for availability of items.

1 kg ≈ 1 daN

APPLICATIONS

Simple and economic, MINIFIX mountings are particularly suitable for the installation of equipment such as:

- Electrical or electronic enclosures.
- Packaging equipment.
- Test and measuring equipment.
- Equipment for the food industry.
- Laboratory equipment.
- Household appliances.