

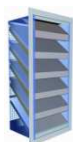

ACOUSTIC GRILLS

The **SE AL1** and **SE AL2** acoustic grills are used in acoustic enclosures in order to reduce the noise, air conditioning and refrigeration systems produce; they also allow air circulation, necessary for their functioning. Our acoustic grills could be installed in the form of entire walls or directly put on the floor; they also can be assembled in technical rooms' walls, instead of traditional grills.

300mm depth version



SE AL1 simple grill

Post	Size (mm)	Debit rate	Charge losses	Price in € (Excluding tax)
1	W=600 x L=600 x D=300	from 0 up to 2,000 m ³ /H	50 Pa	549
2	W=900 x L=900 x D=300	from 0 up to 6,000 m ³ /H	50 Pa	879
3	W=1,200 x L=1,200 x D=300	from 0 up to 12,000 m ³ /H	50 Pa	1,190

600mm depth version



SE AL2 double grill

Post	Size (mm)	Debit rate	Charge losses	Price in € (Excluding tax)
1	W=600 x L=600 x D=600	from 0 up to 1,300 m ³ /H	50 Pa	1,095
2	W=900 x L=900 x D=600	from 0 up to 4,300 m ³ /H	50 Pa	1,760
3	W=1,200 x L=1,200 x D=600	from 0 up to 9,300 m ³ /H	50 Pa	2,190

CARRIAGE COSTS ARE CALCULATED ACCORDING TO THE DELIVERY POINT

Frame

Galvanized steel 15/10
depth 300 mm (SE AL1)
or 600 mm (SE AL2)

Fins

Fixed, made up of galvanized steel 10/10 with a 150 mm pitch
Titled in 40°, filled with rotproof rockwool and protected by a perforated metal sheet:

- Acoustic reduction
- Good rigidity
- Limited charge losses
- Protection against rainwater penetration

Antivolatile shelf

With galvanized steel wire
12 x 25 x 1.5 mm

Flanges

Galvanized steel 15/10, width 40 mm, 10 mm return

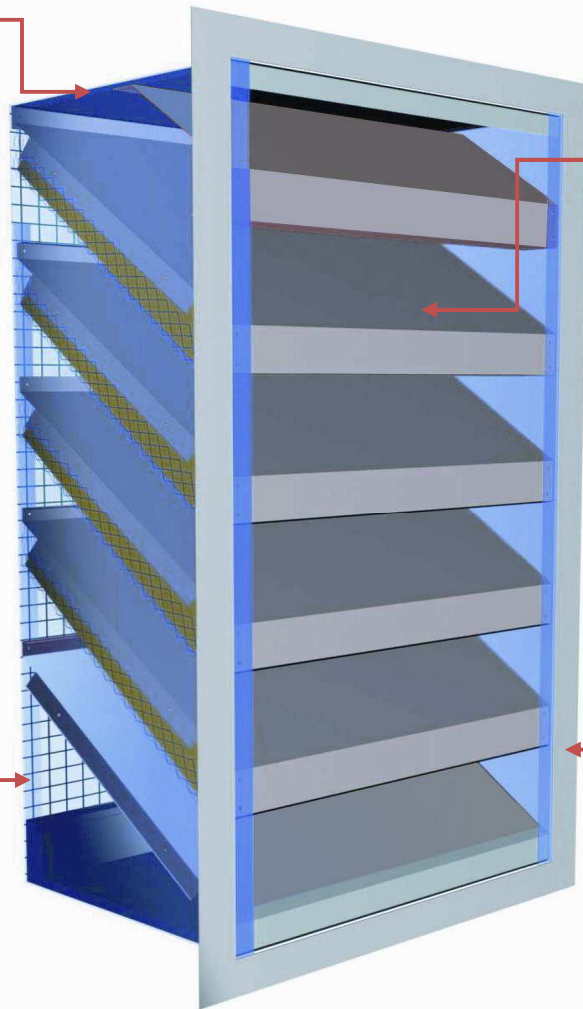

SE AL2

SE AL1

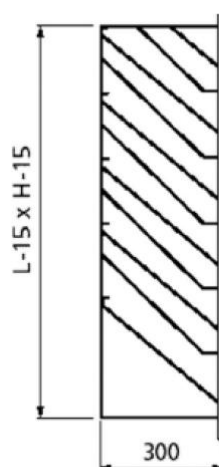
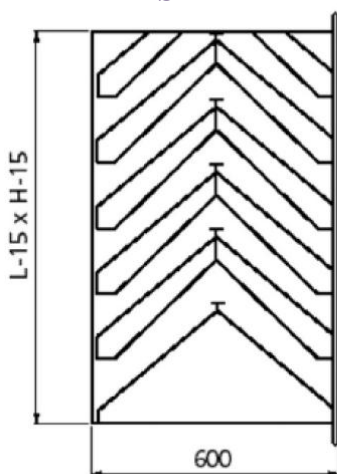

Side views

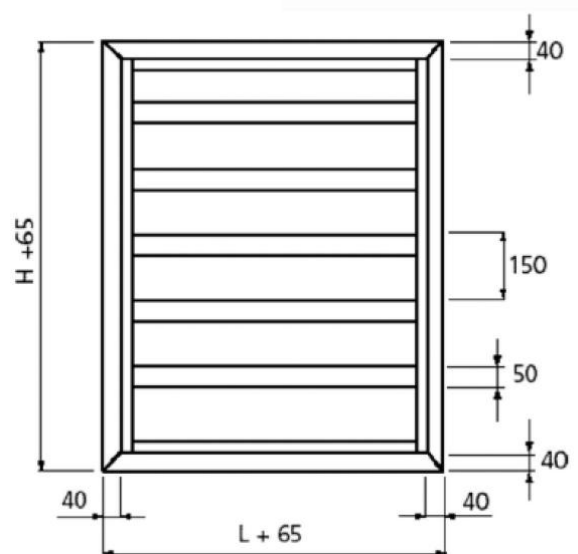

Front views

Technical characteristics:

Static acoustic reduction (dB)								
Frequency (Hz)	63	125	250	500	1,000	2,000	4,000	8,000
SE AL1	5	5	7	12	18	21	16	16
SE AL2	8	9	12	21	32	34	32	32

Charge losses:

SE AL1

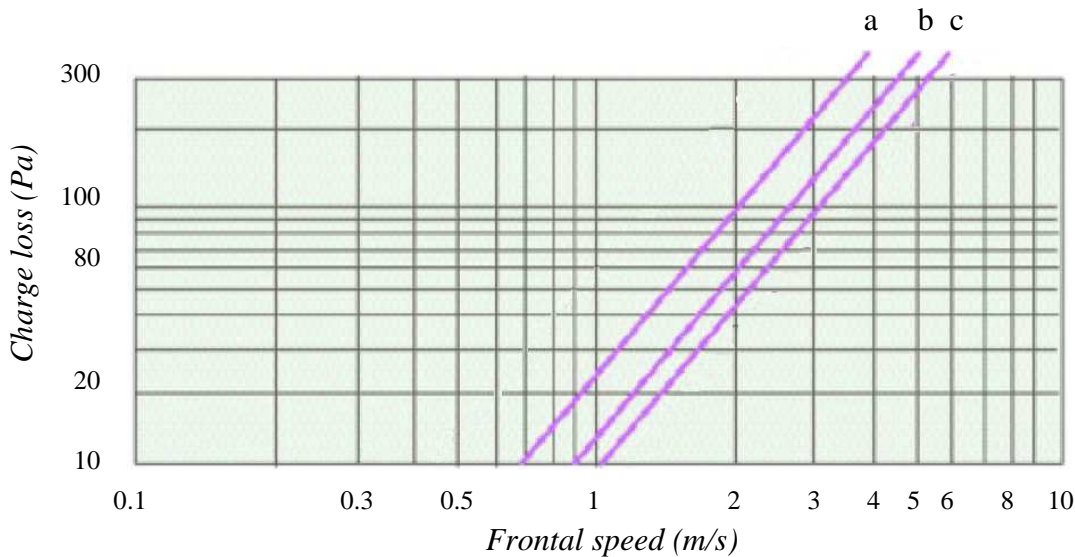

a = 600 x 600 mm
 b = 900 x 900 mm
 c = 1,200 x 1,200 mm

SE AL2

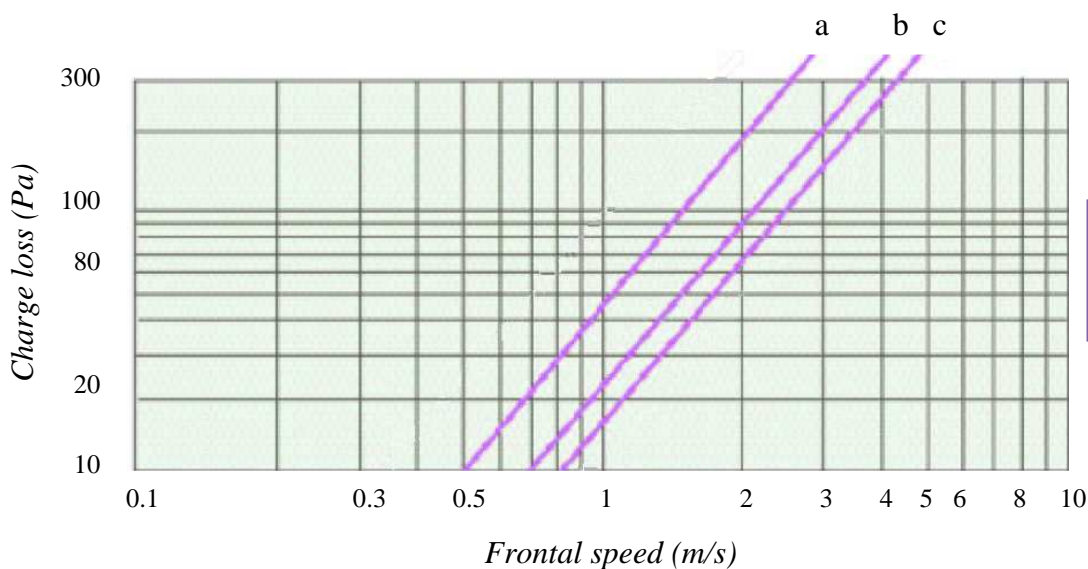

a = 600 x 600 mm
 b = 900 x 900 mm
 c = 1,200 x 1,200 mm

NB : charge loss values, above indicated relate to a covered grill in air introduction.